



404 George Street  
Fitzroy Melbourne  
VIC 3065 Australia  
ABN 14 081 414 273

t +613 9417 1549  
info@ccp.org.au  
www.ccp.org.au

## ARTISTS: SOLO EXHIBITIONS

### CCP EXHIBITION PROPOSAL GUIDELINES

Proposals may be submitted to CCP at any time during the year and are reviewed annually for the following year's program. The deadline for the next review process is **6 May 2011**, for exhibitions in 2012. In each proposal round artists can nominate the preferred period of exhibition within the calendar year of 2012. You will be notified with the result of your application by email by the end of June 2011.

Exhibitions in CCP's five spaces change approximately every seven or eight weeks and feature the work of local, interstate, and international artists. Proposals are accepted from artists and curators and are limited to one per applicant, per year. Proposals are considered by an exhibition advisory committee that includes CCP Director, CCP General Manager, CCP Managing Curator, CCP Associate Curator, a representative from CCP's Board of Management as well as two independent artists or curators.

Proposals should clearly indicate whether the supporting images are the works to be exhibited or indicative works.

**Due to high demand, proposals for solo exhibitions in 2012 will not be considered from artists who presented or will present solo exhibitions at CCP in 2010 or 2011.**

**Please note: Selection preference is given to works not previously exhibited in Melbourne.**

### GENERAL INFORMATION

Designed by award winning Melbourne architect, Sean Godsell, the purpose-built CCP provides contemporary photography with a home worthy of international acclaim. Located in the heart of Melbourne's Fitzroy gallery and cafe precinct, CCP draws a broad audience of approximately 2,500 visitors per exhibition. The gallery is open to the public Wednesday to Friday 11am–6pm and Saturday to Sunday 12–5pm or otherwise by arrangement with the Director. The CCP Night Projection Window is screened on the exterior of the building seven nights a week after dark.

Openings are held on Thursday evenings with exhibition installation commencing on the Tuesday preceding the opening. The opening bar is managed by CCP staff and volunteers and food is not provided. Artist floor talks are held on the Saturday following the opening of the exhibition and all exhibiting artists are expected to participate.

CCP produces a standard electronic exhibition notification emailed directly to a database of approximately 3,000, and has over 4,000 social media contacts through Facebook, Twitter and Flickr. CCP promotes exhibitions through its media channels, but cannot guarantee reviews. CCP does not provide financial assistance with freight or catalogue production without special arrangement or additional funding. **Artists must pay the costs of freighting their work to and from the gallery and install and de-install their work, or pay for professional installation.** CCP can arrange this installation on your behalf.

Exhibitors in all the exhibition spaces receive an art loan fee. Fees are as follows:

Naomi Milgrom and John Kaldor AM **Gallery One** \$700

In Memory of Morry Bardas **Gallery Two** \$700

Helen Macpherson Smith Trust **Gallery Three** \$1,400

**Gallery Four** \$700

**Night Projection Window** \$500

## GALLERY SPECIFICATIONS

### GALLERY 1

Naomi Milgrom and  
John Kaldor AM

Ceiling height • 3180mm  
Walls • steel-studded MDF & plaster  
Floors • concrete  
Lighting • Halogen lamps & floods

**Please note that due to variable climatic conditions Gallery 1  
maybe unsuitable for the presentation of unframed works.**

### GALLERY 2

In Memory of  
Morry Bardas

Ceiling height • 3180mm  
Walls • steel-studded MDF & plaster  
Floors • concrete  
Lighting • Halogen lamps & floods

### GALLERY 3

Helen Macpherson Smith Trust

Ceiling height • 3180mm  
Walls • steel-studded MDF & plaster  
Floors • concrete  
Lighting • Halogen lamps & floods  
Technical • Fixed data projector

### GALLERY 4

Ceiling height • 3180mm  
Walls • steel-studded MDF & plaster  
Floors • concrete  
Lighting • Halogen lamps & floods  
Technical • Fixed data projector

### NIGHT PROJECTION WINDOW

Viewed from the exterior of  
the building

Ceiling height • 3180mm  
Window • 3180mm x 1700  
Projection size • 1275mm x 1700 (3:4 ratio)  
Technical • Fixed data projector  
Projection • Seven nights a week after dark

## INSTALLATION

Installation and de-installation are the responsibility of the exhibiting artist(s). Advice and assistance

should be sought from CCP staff, however CCP does not provide professional installation staff. CCP can provide advice on preferred installation technicians if required and make the arrangements on the behalf of artists. The Director's approval must be sought before any alteration to the gallery is made (eg. colour, surface, partition). **The artist must pay and arrange for any alteration and subsequent return of the gallery to its original condition, which in many instances must be undertaken by CCP's preferred contractors.**

## **INSURANCE**

Please note that the artist's work and any technical equipment that accompanies the exhibition which is not supplied by CCP are not covered by CCP's content insurance. The work and technical equipment is only insured on the premises against loss or damage caused directly by the negligence of CCP staff. Exhibitors wishing to be fully insured against theft, fire, flood, loss or damage must organise this independently in consultation with CCP staff. Any artist whose exhibition involves technical equipment must discuss insurance arrangements in advance with the CCP Managing Curator and in most cases, must cover additional costs incurred.

## **EQUIPMENT**

CCP makes some equipment available for use by exhibiting artists. In some cases, a nominal fee is charged. Artists wishing to use CCP equipment must contact the gallery for further details. Bookings need to be made well in advance.

**PLEASE NOTE: CCP DOES NOT HAVE CLIMATE CONTROL IN ANY OF THE EXHIBITION SPACES.**

## **GALLERY FLOORPLAN**

LINE APPROXIMATES HANGING SPACES

KERR STREET

CEILING HEIGHT = 3180mm  
PROJECTION WINDOW = 3180 x 1700mm  
PROJECTION SIZE 1275 x 1700mm

↑  
N

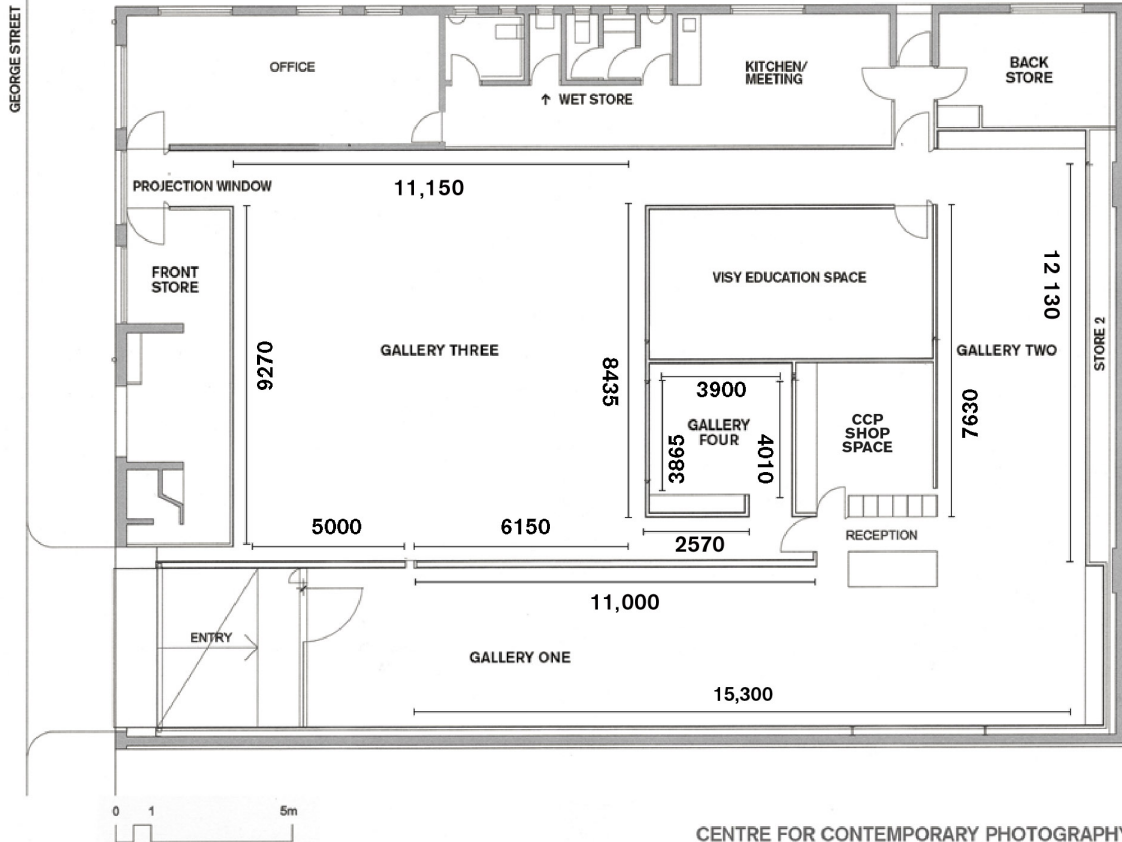

CENTRE FOR CONTEMPORARY PHOTOGRAPHY

## **2011 EXHIBITION ADVISORY COMMITTEE MEMBERS**

### **CCP REPRESENTATIVES**

#### **STAFF**

**Naomi Cass** Director

**Rebecca Chew** Deputy Director

**Kyla McFarlane** Associate Curator

**Karra Rees** Managing Curator

#### **BOARD**

**Daniel Palmer** Chair, CCP Exhibition Advisory Committee;

Writer; Lecturer, Dept of Art Theory, Faculty of Art & Design, Monash University

The exhibition advisory committee will additionally include two independent artists or curators selected at the discretion of CCP Director.